

**workagile**

EDITION 1



**MAKING  
WORK  
AGILE**

**LOOKBOOK**

# Creating an **agile working** environment...

**An agile workplace will always provide choice.** Agile working is all about creating an environment where we can **communicate**, **collaborate**, be **creative** and have the **choice** to work to suit a task or even a mood.

By creating this environment we are facilitating better productivity from our staff and in turn creating a greater sense of **autonomy, happiness and satisfaction!**







# Workspaces are evolving...

With **Well-being** at the heart of ever evolving Workspaces, we are seeing a huge Emphasis on how the workplace is regarded as a symbol of how much an **employer values its employees!** Air quality, temperature, acoustics, interior layouts, lighting, inclusion of natural elements (biophilia) and Furniture Design, each play a key role in the health and wellbeing in the workplace and overcoming work-related illness.

Reducing stress levels and **putting people at ease** will trigger better productivity and put people in a healthier state of **emotional wellbeing**.

This is why at Workagile we adopt an approach based around Salutogenesis!

**SALUTOGENESIS** – what does it mean?

**Salutogenesis is a medical approach focusing on factors that support human health and well-being** (The term was coined by Aaron Antonovsky, a professor of medical sociology) – this should be at the core of our approach for today's evolving workplaces!



“Salutogenesis is a medical approach focusing on factors that support human health and well-being”



# Who are workagile?

'Making Work Agile' is our motto – Designing Furniture to Support, Facilitate and **Empower**  
**Agile Working is our passion!**

We design furniture that makes a meaningful contribution to a truly agile environment – from providing **playful alternatives** to **high quality masterpieces** – Workagile have the solutions.

We want everyone to enjoy work! Can furniture put a smile on your face, why not? Adding a playful twist to what might otherwise be mundane will help create the magic that drives productivity. Workagile have the solutions.

**Workagile - Making Work Agile**

**workagile**  
MAKING WORK AGILE







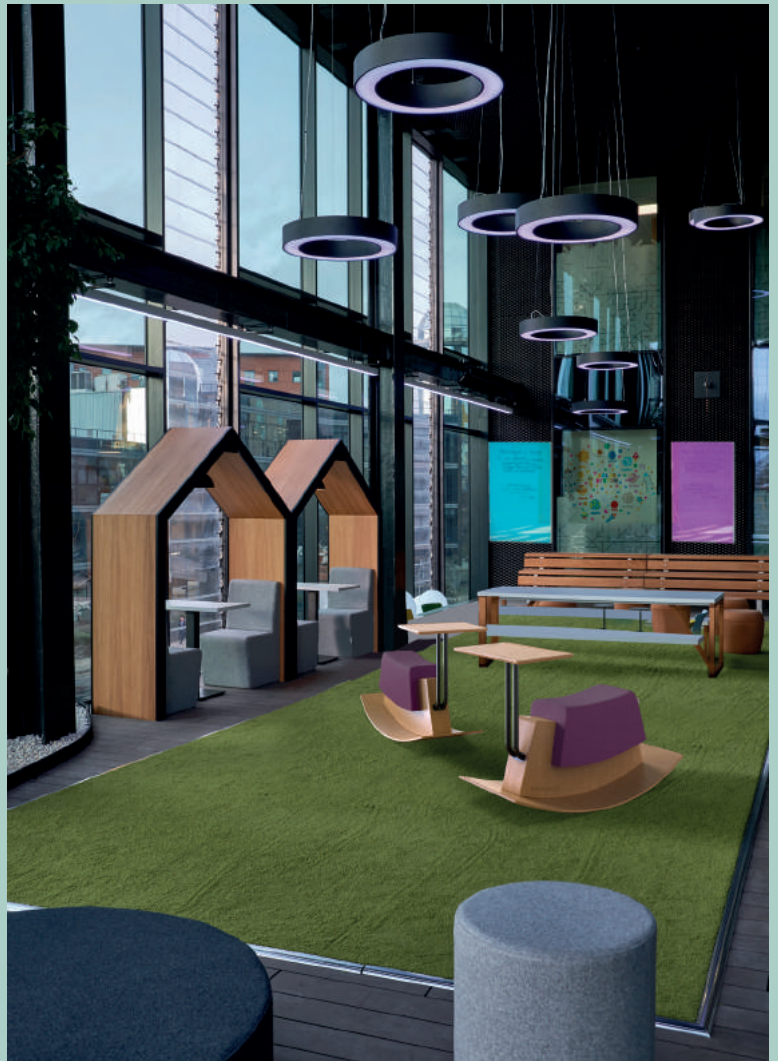

The Rokkadot, a Unique and Fun rocking workstation keeping you moving, keeping you Agile and keeping you smiling!

[workagile.co.uk](http://workagile.co.uk)

# Rokkadot

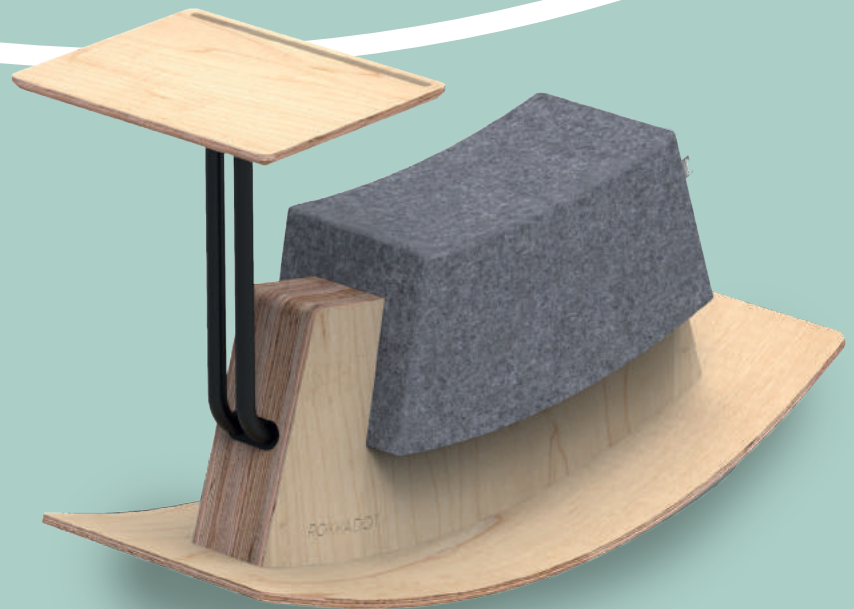

A playful  
alternative to  
either concentrate,  
communicate or  
collaborate.













Huddlebox, no ordinary box – a piece of design engineering, the Huddlebox enables you to create unlimited possibilities - the perfect tiered seating solution to create a flexible zone for meetings, presentations, brainstorming, break out and all things Agile!

[workagile.co.uk](http://workagile.co.uk)

# Huddlebox

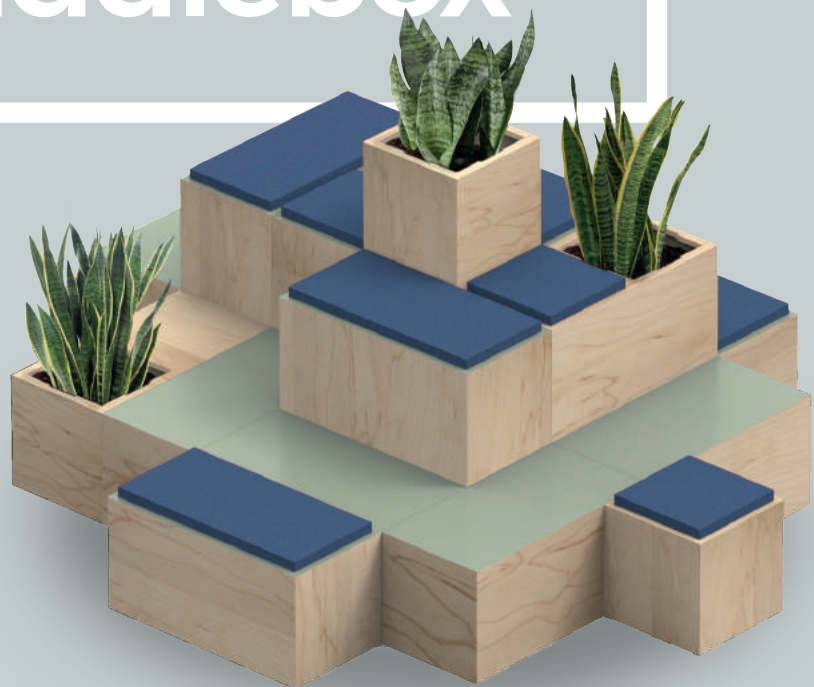

We have a human  
innate tendency  
to climb...













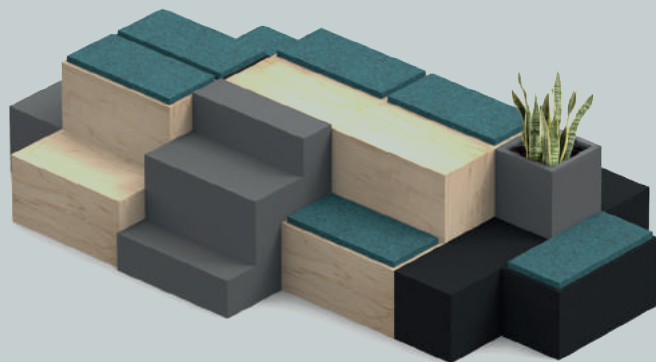
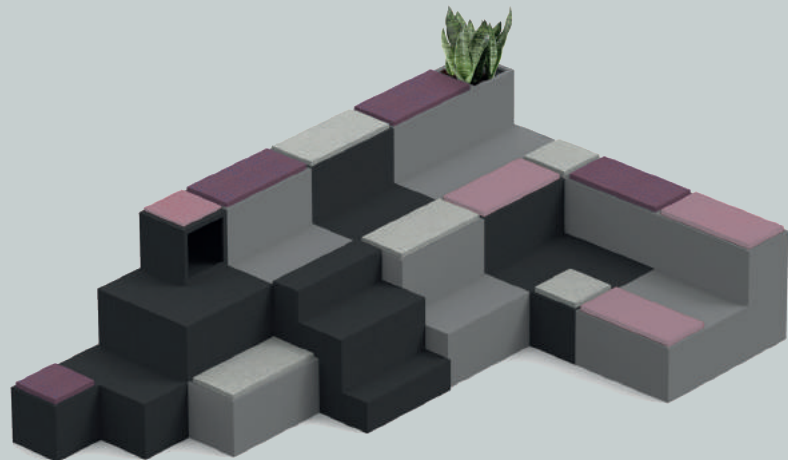
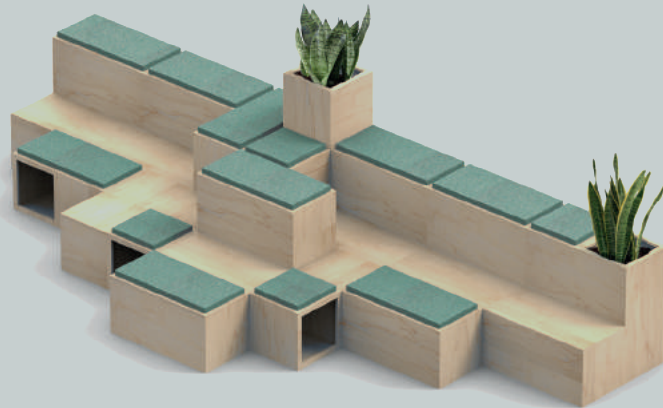
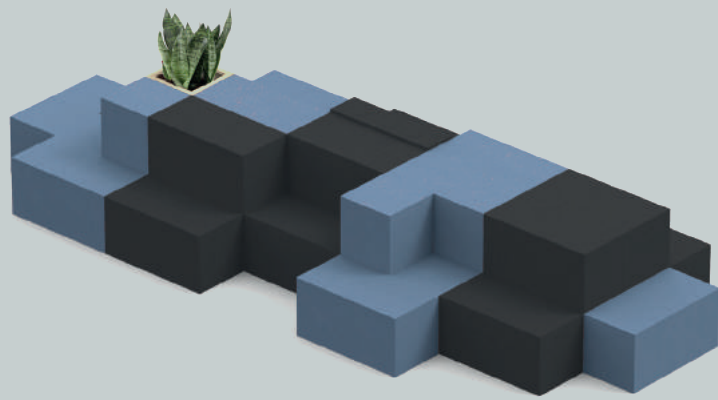







The Shack Booths give the 'out of the office' buzz to any meeting or even somewhere to work quietly alone. With its pitched roof design, shack enhances that 'out of the office' psychology.

[workagile.co.uk](http://workagile.co.uk)

# Shack

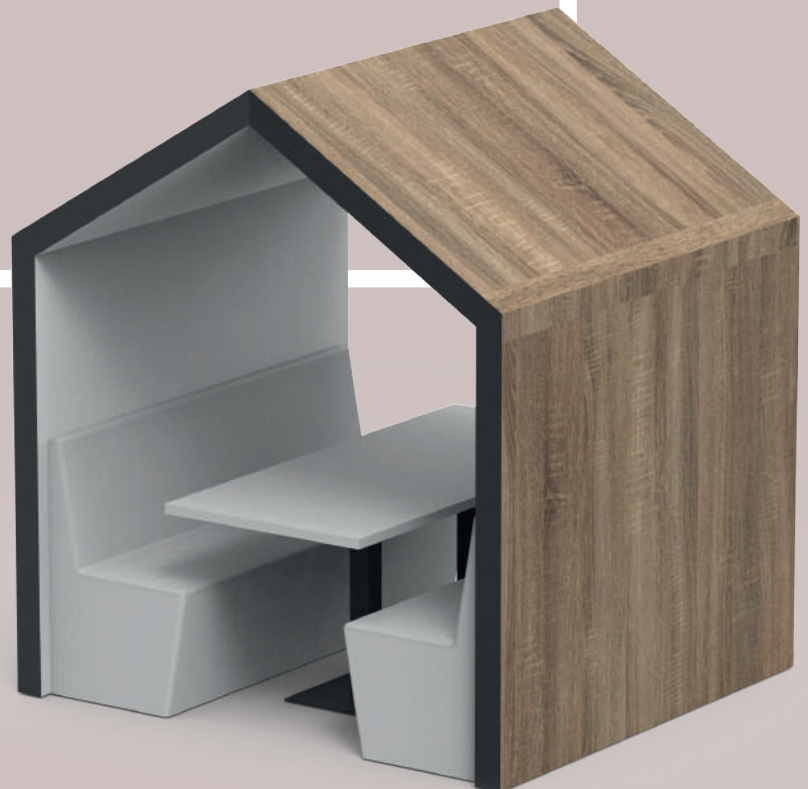

**A Room  
within a Room!**













With Its superior acoustic qualities, Snug is more than just an occasional meeting space. Snug is a 'get things done, get things agreed' focal hub for any workplace environment. With a dry-wipe option to the external shell, Snug becomes a truly agile centre-piece for any workplace.

[workagile.co.uk](http://workagile.co.uk)



**Walk in, Get stuff  
Done, Walk out!**













Every workplace has a need for informal seating 'dotted' about! Dots provides the perfect solution when looking for somewhere to 'perch' within breakout or collaboration areas – ideal for impromptu meetings too!

[workagile.co.uk](http://workagile.co.uk)

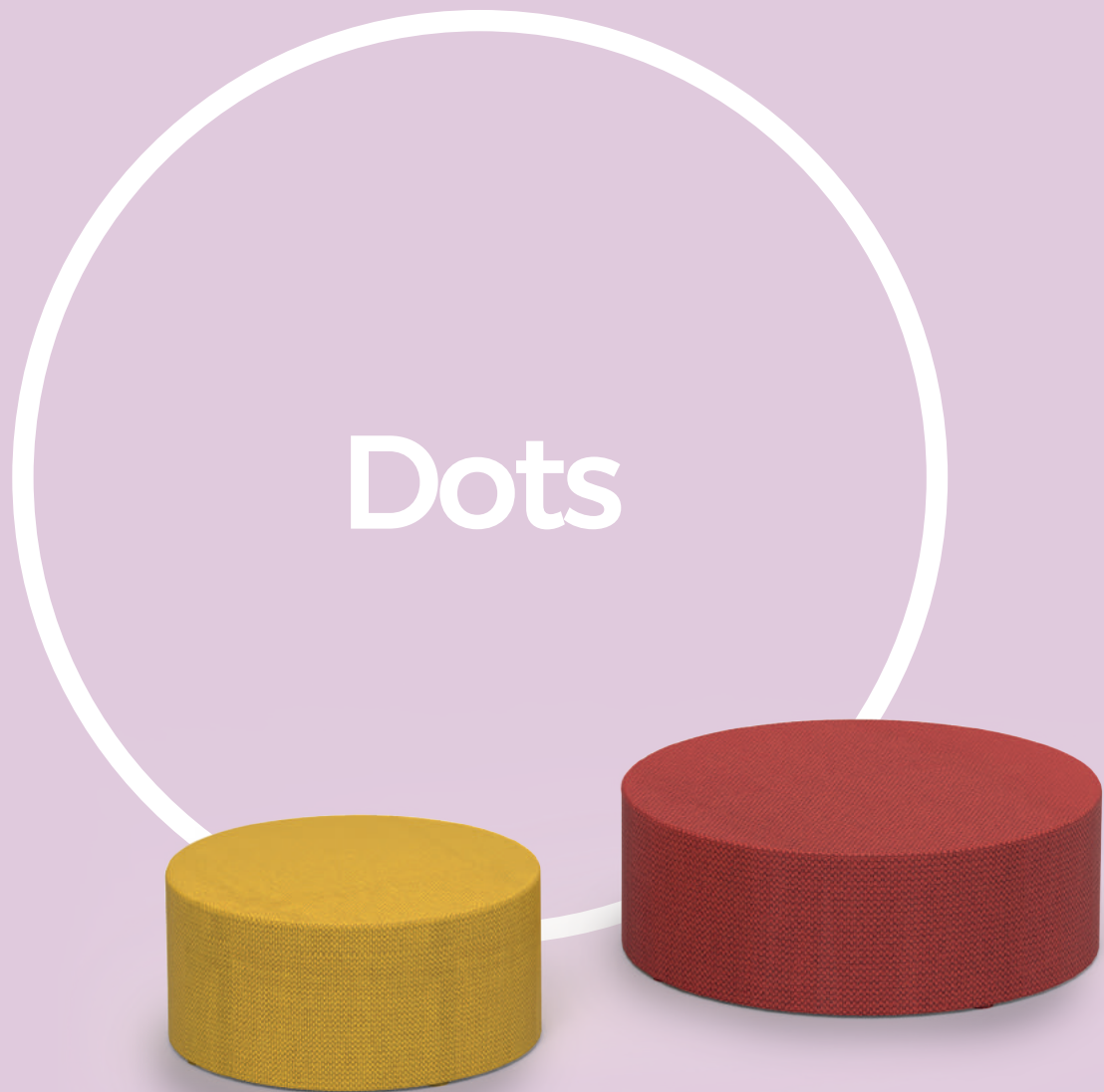

**'Dotted' around the  
workplace creating  
interaction from 'Dot to Dot'**

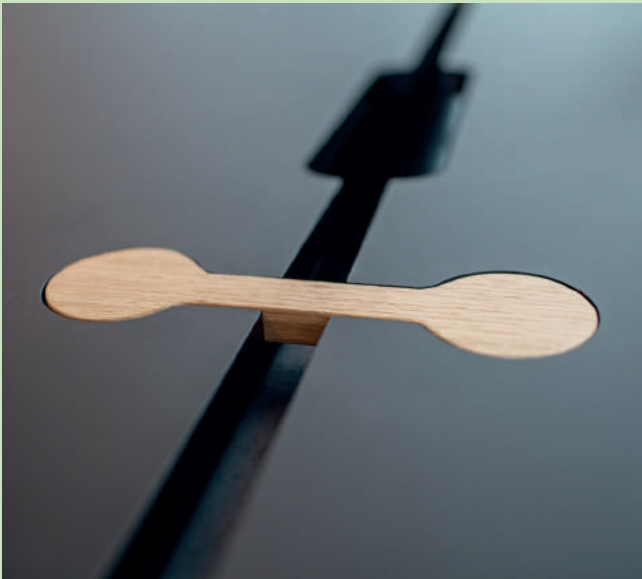



The Mutu promotes highly mutual and collaborative working conditions for multiple persons who can either work for extended periods of time in a single location or collaborate with others for short periods of time. Or both!

[workagile.co.uk](http://workagile.co.uk)

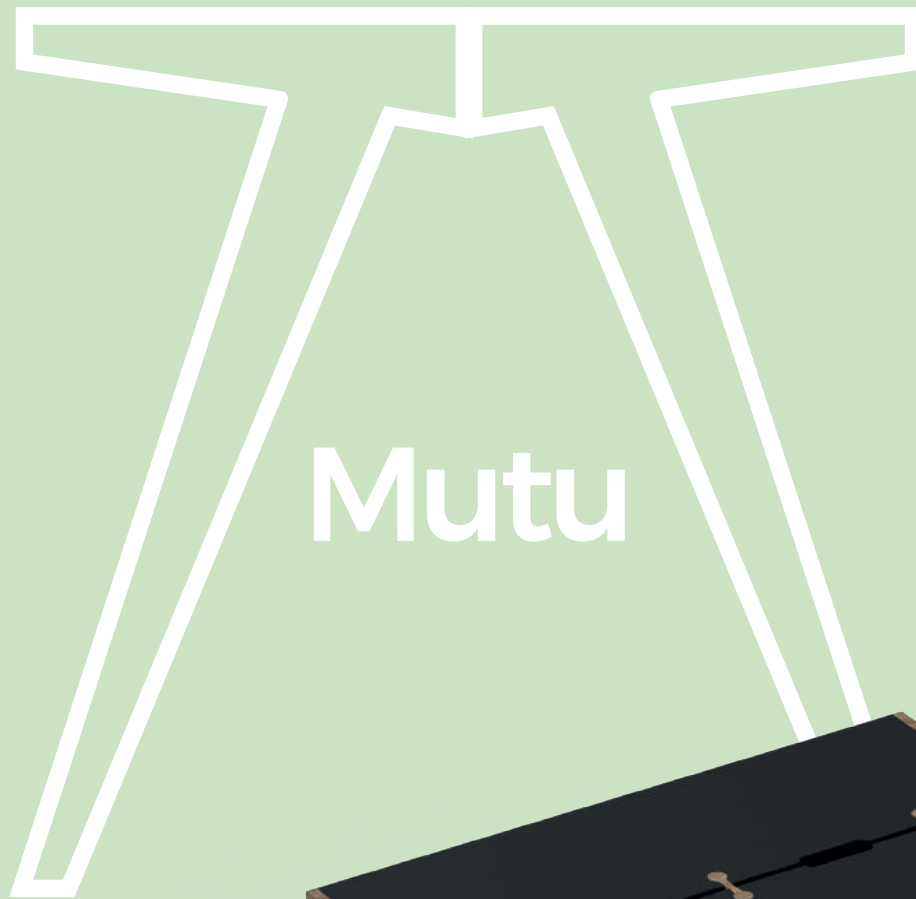

Multifunctional,  
collaboration  
masterpiece!













Design inspiration from the Hague (Den Haag) Straight line Honesty! There is nothing hidden with Haag.  
By bringing the blackened steel structure to the 'outside', Haag is an open book, magically blending the beauty of raw steel and polished timber. Ideal for collaboration, breakout, boardroom or a reception statement piece!

[workagile.co.uk](http://workagile.co.uk)

# Haag



Blending past trends  
into a new open  
minded style.















The office necessity taken to new heights.  
Touch offers incredible durability while the cut-out  
handle and flexy shell form make it the perfect fit  
for any Agile workspace!

[workagile.co.uk](http://workagile.co.uk)

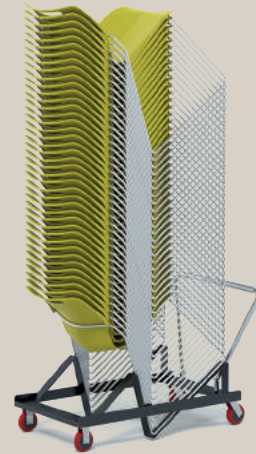

A Splash of  
Colour anyone  
can work with.

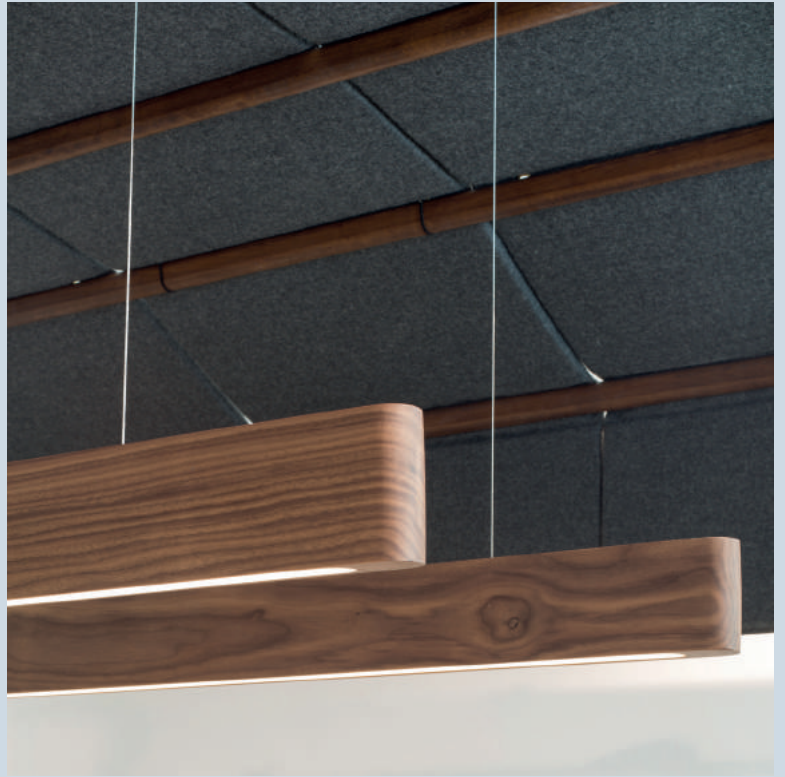



Forbi is a masterful lighting design - helping define space and height! The Solid Timber radius end profiles are one of a kind!

[workagile.co.uk](http://workagile.co.uk)

# Forbi



A Design  
statement in  
it's own right!





Taking 'acoustic booths' to new heights – whether to make a confidential call or a business skype presentation to Dubai, MiiBOX is really yours! The only Triangle Booth available in the World - MiiBOX!

[workagile.co.uk](http://workagile.co.uk)

# MiiBOX



I might just get  
in 'MiiBOX'!

# FORM

Getting some fresh air



# CLAAB

Timelessly stylish





# Coming Soon...



**ZEN**  
The value of meditation and intuition

# Helping HSBC to work agile

Workagile worked extensively with Axis Architecture and Insightful Environments to help bring the vision of HSBC, the worlds local bank, to life. The brief included consideration of the environment, to create a vibrant stress-free space including various collaboration areas and to ensure employees benefitted from a stylish, state of the art office that delivered a diverse, interactive working environment.

Workagile's Huddlebox, Haag, MuTu and Snug products were utilised in such a way to create a cultural shift from a static to a flexible working environment within a contemporary professional environment. The desk sharing ratios were designed to encourage different more agile ways of working and the clients appreciated the multi-functionality of Snug with its write-on walls to that could be used as an impromptu whiteboard as needed.

**"3 words that spring to mind when I think of Workagile... Premium, Quality, Service. They have interesting products that are well-made and different to other products on the market. The team are helpful and knowledgeable, and I recommend visiting the showroom! We chose Haag & MuTu because they are very well-made tables – they provide a nice and different design to others available on the market; Huddlebox is also slightly different to other modular type seating available at the moment. Workagile's service levels are good and they offer real value for money. I have no reason not to recommend them."**

– Tony Brown, Director, Axis Architecture.

Workagile was on hand to advise during the early design phases and followed the project to completion and handover to the client. We also provided samples, trials and designs to help ensure the furniture would suit the vision HSBC wanted for their new office.



“3 words that  
spring to mind  
when I think of  
Workagile...  
Premium,  
Quality, Service.”



# Deliveroo rock the Rokkadot

Rokkadot makes a highly meaningful contribution to creating a communicative, collaborative and inspiring workplace. It's definitely a smile generator amongst team members and visitors.

We launched Rokkadot at Clerkenwell Design Week where it was received with great enthusiasm; and it was there Workagile met the team from Deliveroo who loved the fun concept.

Giants in the food delivery game; Deliveroo was founded in 2013 and has grown rapidly over the past six years to achieve worldwide success. They work with some of the biggest restaurant chains and food outlets in the business and operate in over 200 cities across the world with their HQ located in London.

We have worked closely with the brand on their agile workspaces and after some initial collaboration with them, Deliveroo were keen to try the Rokkadot out in the team event/breakout space.

**The Rokkadot is a rocking seat with an integrated work platform for your laptop, notes and devices.**

With its playful nature, echoing the childhood rocking horse the Rokkadot not only adds fun to any office environment but also boasts benefits such as reducing stress and improving wellbeing. The rocking movement puts people at ease, which encourages productivity and puts people in a healthier state of emotional wellbeing.

Creating exciting and liberating spaces for people to work in is known to improve creativity, sense of autonomy, happiness and job satisfaction and promotes 'Salutogenics' – which is the ability to cause human health & wellbeing.

Working with the Deliveroo team we were able to create a suite of Rokkadot's that aligned with the branding of the company. We selected fabrics to link in with their branding as well as bespoke upholstery incorporating the Deliveroo logo for a truly unique look and feel.



“The rocking movement puts people at ease, which encourages productivity.”

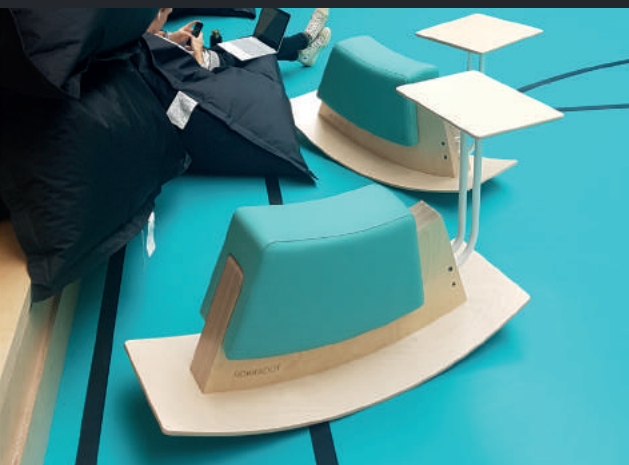



1 Britannia Lofts,  
16-26 Banner Street,  
Clerkenwell,  
London,  
EC1Y 8QE.

**Phone:** 020 3904 6688

**Email:** [london@workagile.co.uk](mailto:london@workagile.co.uk)

**Web:** [www.workagile.co.uk](http://www.workagile.co.uk)